

DARK BEAUTY

A VIBRANT MIX OF KITCHEN FINISHES AGAINST NEUTRAL-COLOURED FLOORS AND WALLS ADDS UP TO A STRIKING RESULT ON A TIGHT BUDGET

WORDS/STYLING **ANDREA CAMPOS** PHOTOGRAPHS **AMANDA PRIOR**

ARCHITECT'S TIP "EVERY KITCHEN NEEDS TO WORK AESTHETICALLY WITH THE HOME," SAYS SHANE BLUE OF BOURNE + BLUE ARCHITECTURE. "IT NEEDS TO HAVE A CERTAIN LOGIC ABOUT HOW THE FOOD IS STORED, COOKED AND SERVED, AND HOW THE CLEANING IS DONE. A KITCHEN SHOULD BE TAILOR-MADE TO SUIT THE CLIENT AND THE HOUSE"



→ **BRIEF** A busy professional and accomplished chef, the client wanted a practical new kitchen. She expressed a preference for high benchtops, windows at bench level (allowing visual access outside) and colour. She also wanted her kitchen to complement the adjacent living area.

→ **BUDGET** \$13,700 plus appliances.

→ **SOLUTION** Architect Shane Blue designed a kitchen to tantalise any culinary enthusiast. The storage is at one end, while the cooking, serving and washing areas are set to one side. A bench for food preparation and entertaining faces the living space. This kitchen fit-out was part of the construction of a new two-level residential dwelling also designed by Shane.

→ **ARCHITECTURE AND DESIGN**

Shane Blue of Bourne + Blue Architecture, Newcastle NSW (02) 4929 1450.

→ **JOINERY** KJ & PM Thomas,

Newcastle NSW (02) 4942 6385.

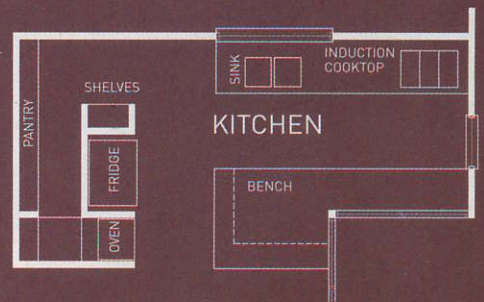

OPEN STORAGE The expansive storage shelves beneath the benchtop have several advantages, according to Shane. As well as providing plenty of storage space that is easily accessible, visually and physically, the shelves allow a sleek, minimalist kitchen to display the client's collection of favourite cookware and tableware.

BRIGHT BENCHTOP MAX Laminate in Red was chosen for the new kitchen benchtop, for both its rich, welcoming colour and the variety of dimensions in which it is available.

"One of the main advantages of using laminate for a benchtop is that it comes in sheets large enough for a bench like this to be in one sheet," explains Shane. "I also find it to be a much warmer material to be close to and sit and look at." →